



SERVICE BULLETIN

Classification: RS99-001c	Reference: NTB99-022c	Date: August 5, 2003
------------------------------	--------------------------	-------------------------

FRONT SEAT BELT LATCH PLATE RETAINING BUTTON MISSING

The Applied Vehicles and Service Information sections of this bulletin have been revised.
Please discard all previous copies of NTB99-022.

- APPLIED VEHICLES:**
- 1995 – 1998 200SX (B14) - 2 door
 - 1989 – 1994 240SX (S13)
 - 1995 – 1998 240SX (S14)
 - 2003 350Z (Z33)
 - 1995 – 1997 Altima (U13)
 - 1998 – 2001 Altima (L30)
 - 2002 – 2003 Altima (L31)
 - 1998 – 2003 Frontier (D22)
 - 1995 – 1999 Maxima (A32)
 - 2000 – 2003 Maxima (A33)
 - 2004 Maxima (A34)
 - 2003 Murano (Z50)
 - 1987 – 1995 Pathfinder (WD21)
 - 1996 – 2003 Pathfinder (R50)
 - 1996 – 1998 Quest (V40)
 - 1999 – 2002 Quest (V41)
 - 2004 Quest (V42)
 - 1995 – 1999 Sentra (B14) - 4 door
 - 2000 – 2004 Sentra (B15)
 - 1986.5 – 1997 Truck (D21)
 - 2000 – 2003 Xterra (WD22)

IF YOU CONFIRM:

- The front seat belt latch plate of an applied vehicle slides to the end of the seat belt, sliding down the belt to the floor at the base of the B pillar.
- This happens because the seat belt latch plate retaining button is lost or damaged.
- The seat belt and retractor are in serviceable condition,

ACTION:

Use this bulletin to replace the retaining button and clean, and refurbish the driver's and passenger's front seat belt "D" rings.

NOTE: This button is required to hold the seat belt latch plate at the shoulder location, preventing it from sliding to the floor when the belt is released.

NOTE: The purpose of “**ACTION**” (page 1) is to give you a quick idea of the work you will be performing. You must closely follow the entire Service Procedure (below) as it contains information that is essential to successfully completing this repair.

PARTS INFORMATION

DESCRIPTION	PART NUMBER	QUANTITY
Stopper-Tongue	87832-4P000	1
Seat Belt, Tape Set	87880-79900	1

CLAIMS INFORMATION

NOTE: This is the ONLY approved repair procedure for this incident. Claims to Nissan for the repair of this incident may be denied if the repairs are not performed exactly as outlined in this bulletin.

Submit a separate Primary Failed Part (PP) line using the following claims coding:

DESCRIPTION	PFP	OP CODE	SYM	DIA	FRT
RPL Seat Belt Stopper	87832-4P000	VK40AA	ZE	69	0.2 hrs.*
Clean "D"-ring and apply tape, both sides		VX04AA			0.4 hrs.

* FRT includes sufficient time to replace both seat belt stoppers per vehicle if required.

SERVICE PROCEDURE

NOTE: DO NOT REPLACE the front driver’s or passenger’s seat belt assemblies before first using the Service Procedure in this bulletin to:

- Replace the missing/broken retaining button(s), and
- Clean the "D" rings and install the fluorine resin tape on both seat belt assemblies.

Replace Missing/Broken Retaining Button

1. Make sure the seat belt is not ‘twisted’ by sitting in the seat and latching the seat belt. If the belt is twisted, correct this before beginning button replacement.
2. Determine the original retaining button position.

CAUTION: It is important that the replacement button be positioned on the seat belt exactly where the original button was placed at the factory.

- Find the “witness mark” (the old hole) for the old button, using the information contained in Figure 1 and Table 1 (page 3)

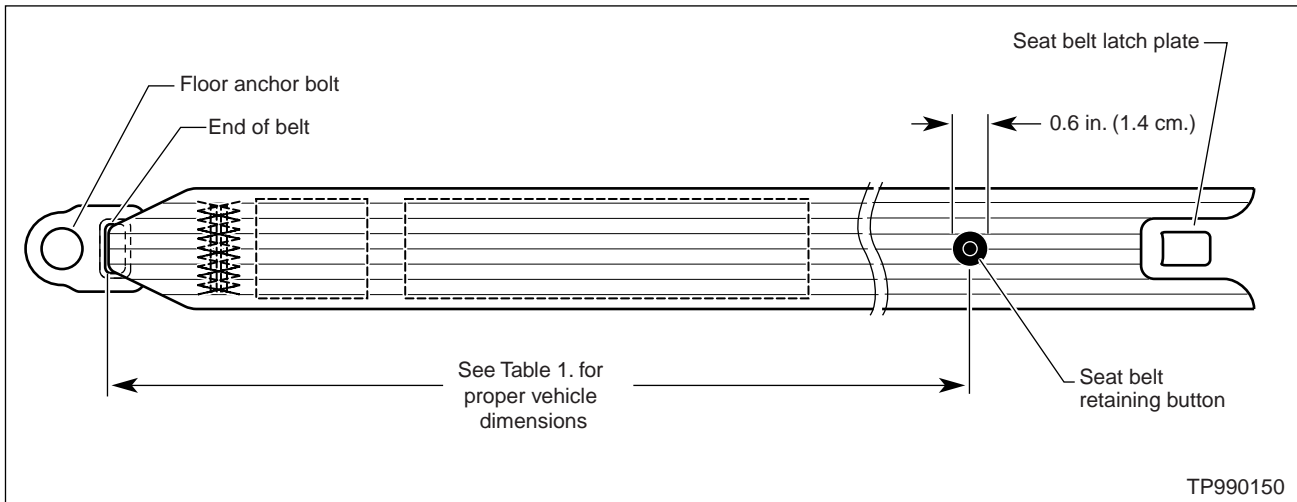

Figure 1 – Location of the seat belt retaining button and latch plate.

VEHICLE	BUTTON DISTANCE FROM END OF SEAT BELT
200SX (B14)	23.5 in. (60 cm)
240SX (S13)	23.5 in. (60 cm)
240SX (S14)	22.8 in. (58 cm)
350Z (Z33) 2003	22.6 in. (57.5 cm)
Altima (L30) - 1998-99	23.5 in. (60 cm)
Altima (L30) - 2000-01	24.2 in. (61.35 cm)
Altima (L31) – 2002-03	25.5 in. (65 cm)
Frontier (D22) 1998-2001	25 in. (63.35 cm)
Frontier (D22) 2002-2003	LH 29.5 in. (74.5 cm) RH 25 in. (64 cm)
Frontier Crew Cab (D22) 2000-2001	25 in. (63.35 cm)
Frontier Crew Cab (D22) 2002-2003	LH 29.5 in. (74.5 cm) RH 25 in. (64 cm)
Maxima (A32)	25.5 in. (65 cm)
Maxima (A33)	26.2 in. (66.5 cm)
Maxima (A34)	23 in. (58.5 cm)
Murano (Z50)	25.3 in. (64.3 cm)
Pathfinder (WD21)	24.5 in. (62 cm)
Pathfinder (R50) – 1996-99	23.5 in. (60 cm)
Pathfinder (R50) – 2000-03	27.3 in. (69.3 cm)
Quest (V40)	20.5 in. (52 cm)
Quest (V41)	20.5 in. (52 cm)
Quest (V42)	28.5 in. (72.5 cm)
Sentra (B14)	22.5 in. (57 cm)
Sentra (B15) 2000-2003	24.2 in. (61.35 cm)
Sentra (B15) 2004	24.5 in. (62 cm)
Truck (D21)	24.5 in. (62 cm)
Xterra (WD22) 2000-2001	25 in. (63.35 cm)
Xterra (WD22) 2002-2003	LH 29.5 in. (74.5 cm) RH 25 in. (64 cm)

Table 1.

- Slide the seat belt latch plate to a position higher than the button position (i.e., between the button location and the shoulder anchor loop). See Figure 2.
- Find the original button position (hole). Then insert the button half (with the center pin) into the belt. Go in from the plastic side of the latch plate (see Figure 2).

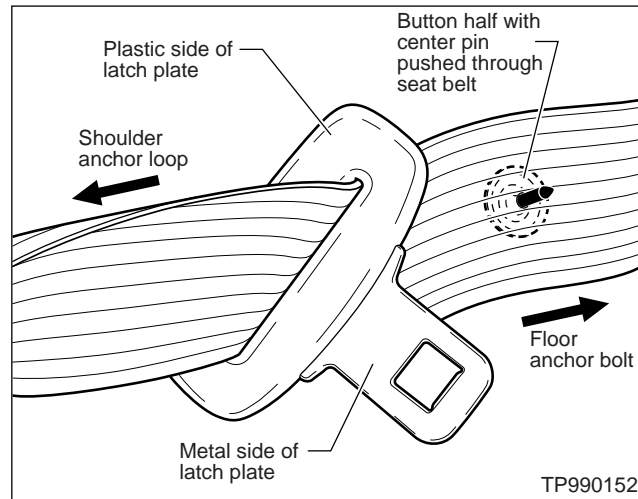

Figure 2 – Positioning latch plate and inserting retaining button half with center pin

- On the opposite side of the belt (on the metal side of the latch plate) fit the button half with the hole over the protruding pin (see Figure 2 & 3).

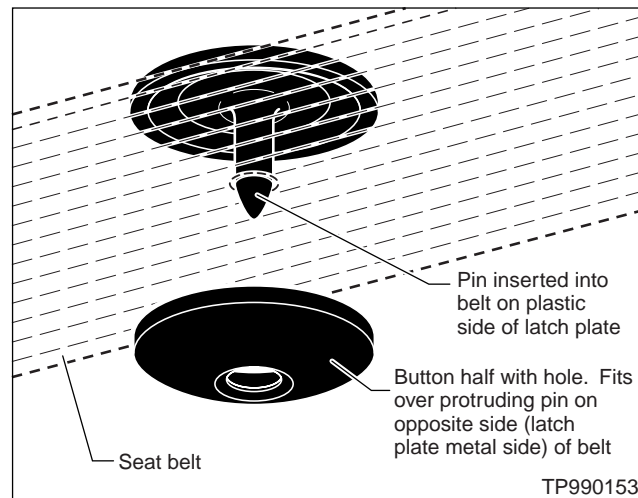

Figure 3 – Fitting retaining button half with hole over the center pin

6. Use an adjustable wrench with smooth jaws. Place it as shown in Figure 4, then finger tighten the jaws.

CAUTION: Do not use pliers to squeeze or compress the button halves together. This can scratch and/or damage the button.

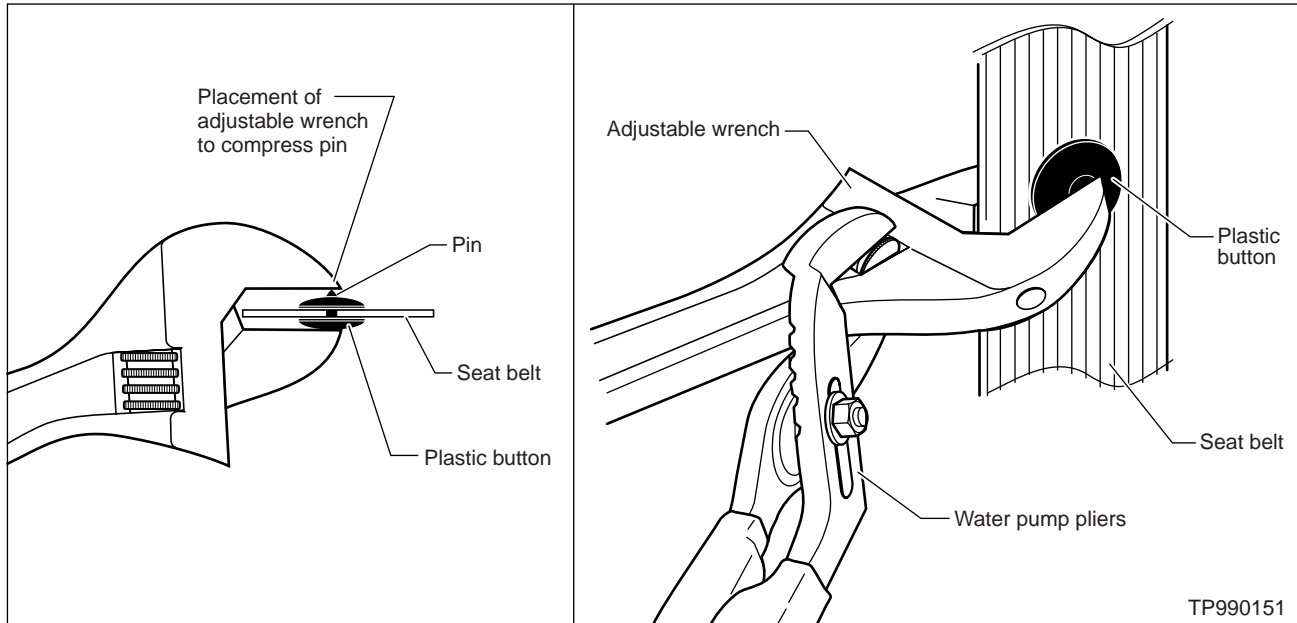

Figure 4 – Using wrench and pliers to compress the latch plate retaining button

7. Using waterpump pliers, tighten the adjustable wrench. Compress the button to approximately 0.2 in. (5.4-5.8 mm) thickness (see Figure 4).
8. Make sure the center pin of the button is securely crimped to hold the other half of the button in place (see Figure 2 on page 4).
9. Confirm that the seat belt latch plate cannot slide past the button and it is held at shoulder height when the seatbelt is retracted.

NOTE: When this incident occurs, both front driver's and passenger's seat belt "D" rings must be cleaned and "refurbished" (renewed) using the following procedural steps.

Clean "D" Ring, Install Fluorine Resin Tape

NOTE: For 1996-99 Pathfinders built before December, 1998, see bulletin NTB00-003 for additional front seat belt retractor assembly information.

1. Pull the affected seat belt more than 20 inches (500 mm) out of the B pillar seat belt retractor mechanism (see Figure 5).
2. Attach a binder clip (or similar clamping device) to the seat belt at the base of the retractor mechanism to allow for slack in the seat belt (see Figure 5).

CAUTION: Be careful not to damage the seat belt fabric when attaching or removing the clip.

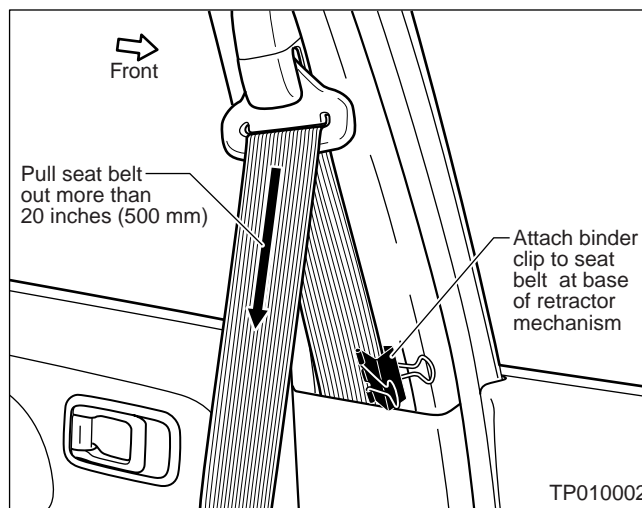

Figure 5

3. Insert the "D" ring cleaning wire (provided in the kit listed in the PARTS INFORMATION section of this bulletin) under the seat belt, between the belt and the "D" ring (see Figure 6).

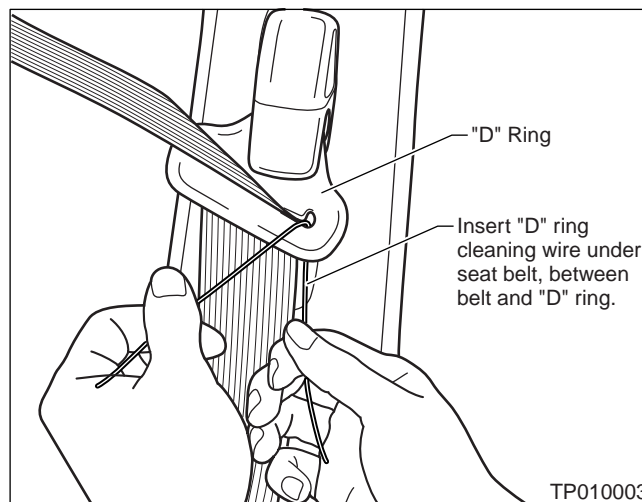

Figure 6

4. Pull the wire back and forth across the surface of the "D" ring, sliding it over all areas of the "D" ring where it contacts the seat belt (see Figure 7) until all residue is removed.

NOTE: It is very important to remove all residue buildup from the "D" ring before the following steps of the procedure are completed. Failure to remove all residue build up will result in poor adhesion of the special fluorine resin tape.

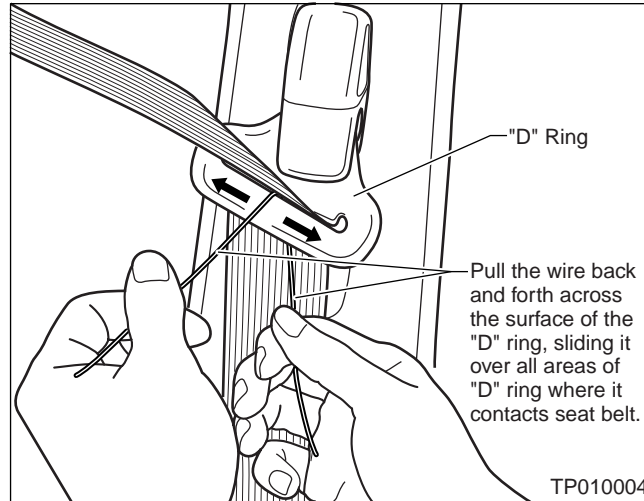

Figure 7

5. Peel off the top (smaller) backing sheet from one of the two fluorine resin tape sections provided in the kit (see Figure 8).

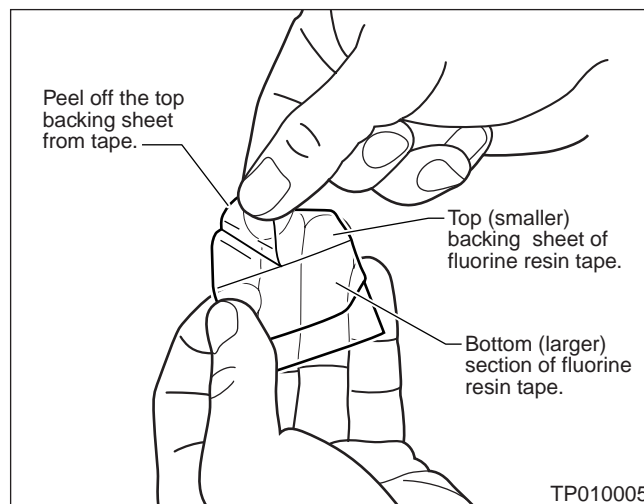

Figure 8

- Place the fluorine resin tape (adhesive side toward you) against the seat belt as shown in Figure 9A.

NOTE: The top section of the tape (from which the backing sheet was peeled off in step 5 on page 7) should be placed so that it is pointing down toward the floor of the vehicle. The “unexposed” bottom section of the tape should be pointing up toward the ceiling of the vehicle (see Figure 9A).

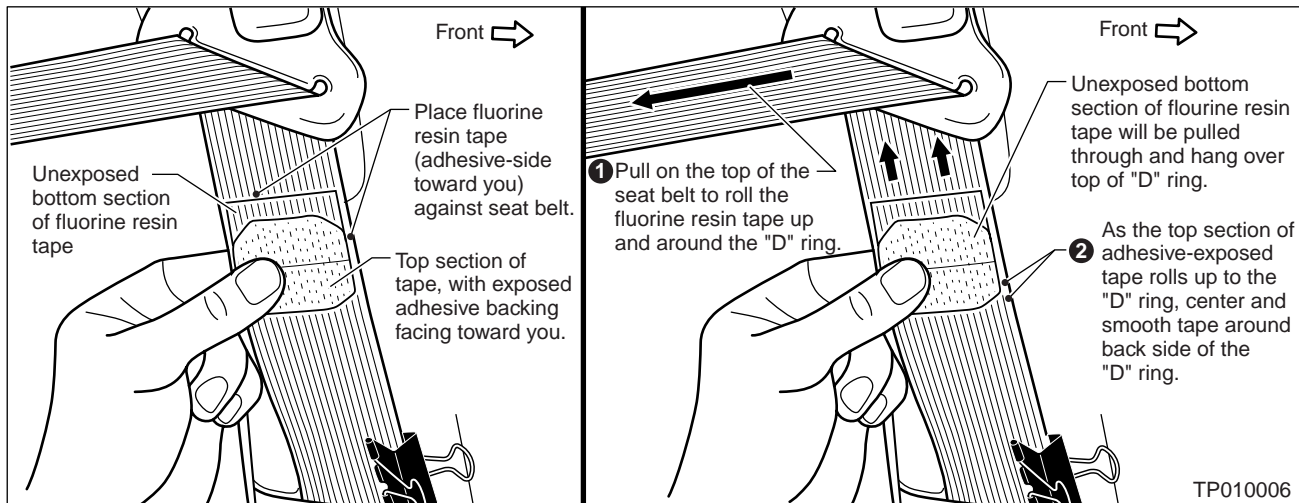

Figure 9A

Figure 9B

- Pull on the top of the seat belt to roll the tape up and around the "D" ring (see Figure 9B).

- The unexposed bottom section of the tape will be pulled through and hang over the top of the "D" ring (see Figure 9B). Stop pulling when you see this.

- As the top section of the adhesive-exposed tape rolls up to the "D" ring, center and smooth the tape around the back side of the "D" ring (see Figure 9B above and Figure 10 on page 9).

NOTE: Once the fluorine resin tape is applied to the "D" ring, it cannot be repositioned. Take care to properly attach the tape to the "D" ring. Center the tape correctly on the "D" ring and smoothly apply it to the "D" ring surface in these procedural steps so that no wrinkles or ridges are present.

IMPORTANT: Wrinkles or ridges in the tape may prevent the seat belt from moving smoothly through the "D" ring. Replace the tape with a new piece if this should occur.

9. Run your finger over the surface of the newly applied tape to firmly apply it to the back side of the "D" ring. Press down the edges of the tape, and smooth out any air bubbles or wrinkles (see Figure 10).

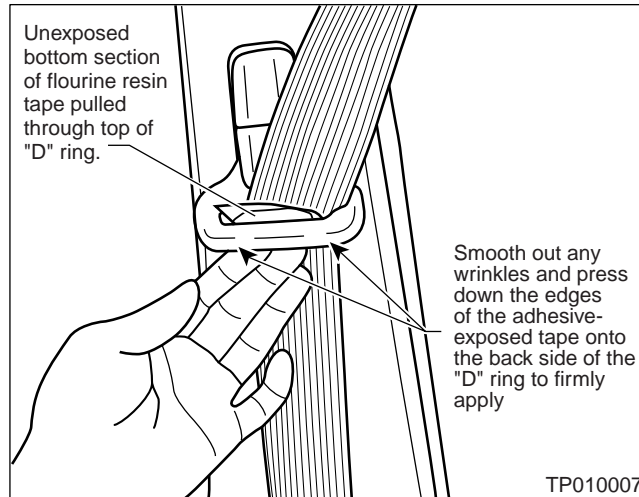

Figure 10

10. Peel off the remaining, unexposed bottom section of the tape backing (see Figure 11A).

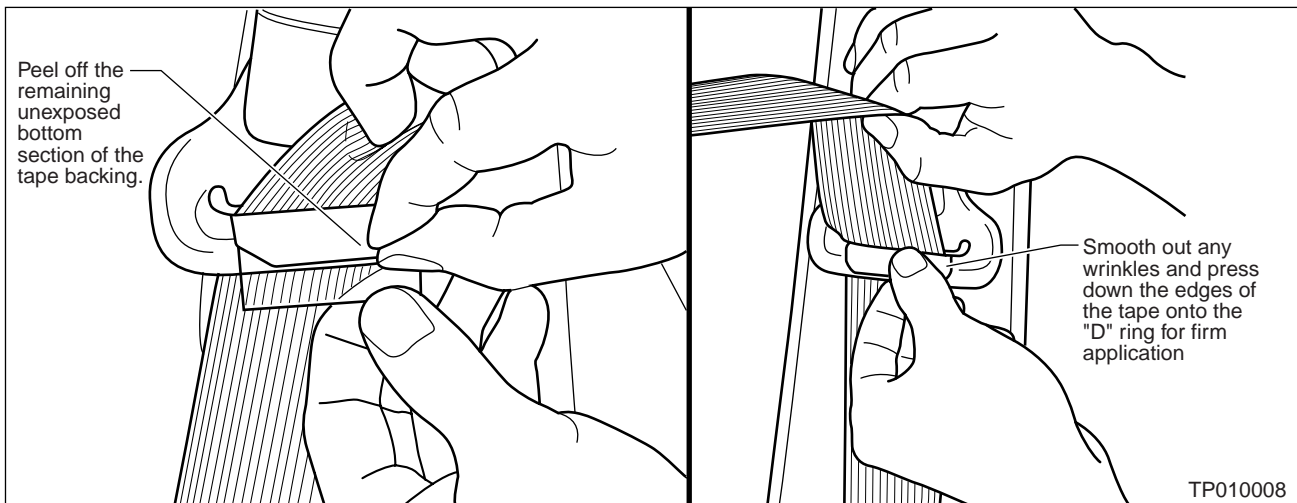

Figure 11A

Figure 11B

11. Carefully apply the tape around the remainder of the "D" ring. Take care to apply the tape so that no wrinkles are present. Press down the edges of the tape (see Figure 11B).

12. Pull the seat belt back and forth against the tape-covered "D" ring to make sure that the tape is firmly applied (see Figure 12).

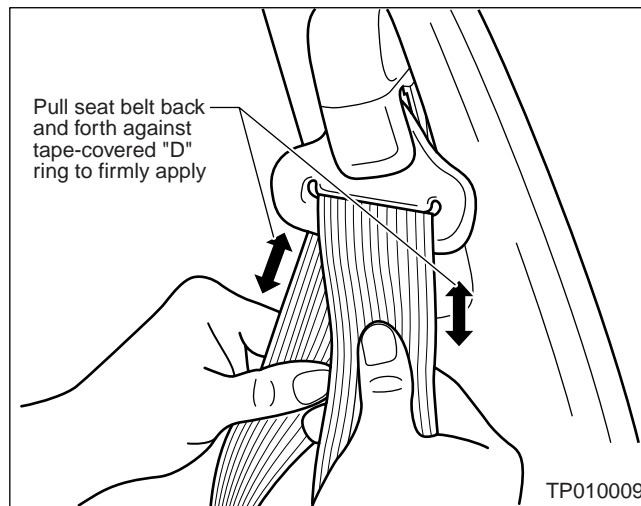

Figure 12

13. Remove the binder clip from the seat belt.

14. Confirm that the seat belt moves smoothly and quickly through the "D" ring by latching and unlatching it and allowing it to retract back into the retractor mechanism several times.

15. Repeat steps 1 through 14 of this procedure on the remaining front seat belt.

